

$$2.40 \times 6.00 = 14.40 \text{ m}^2$$

MODÜL SİSTEM KONTEYNER PLANLARI

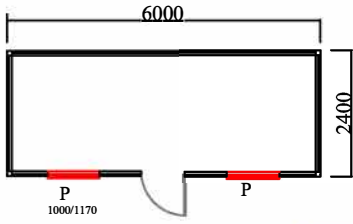

TİP KA 1-6

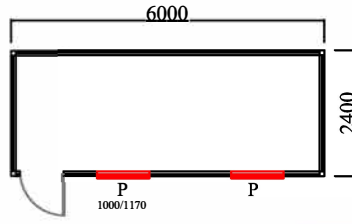

TİP KA 2-6

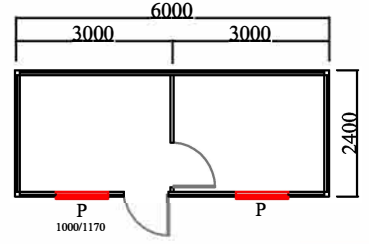

TİP KB 1-6

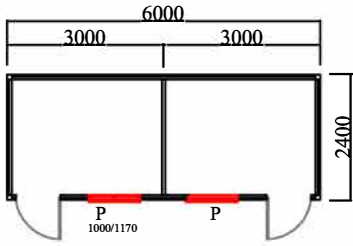

TİP KB 2-6

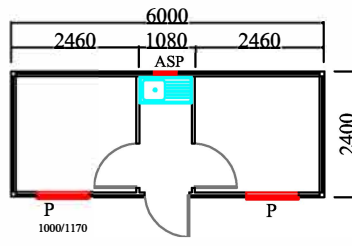

TİP KC 1-6

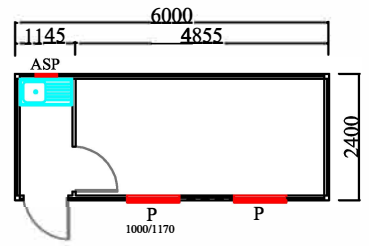

TİP KC 2-6

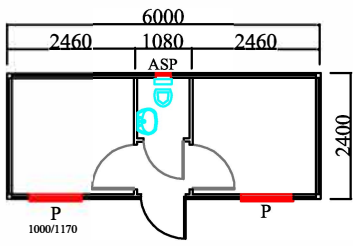

TİP KD 1-6

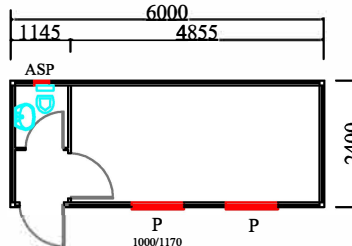

TİP KD 2-6

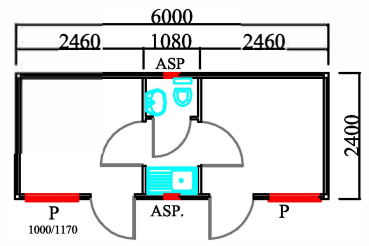

TİP KE 1-6

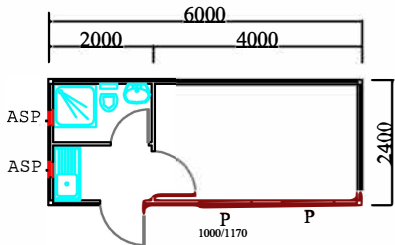

TİP KE 2-6

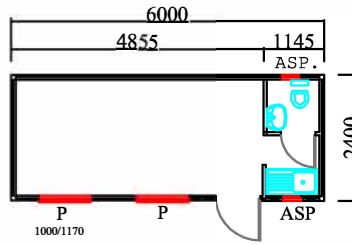

TİP KE 4-6

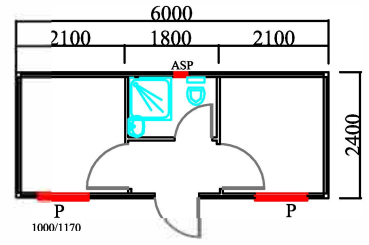

TİP KF 1-6

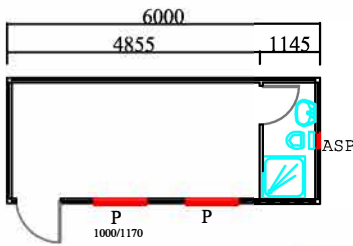

TİP KF 2-6

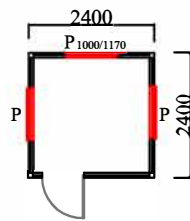

TİP KA 3

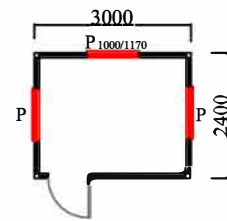

TİP KA 4

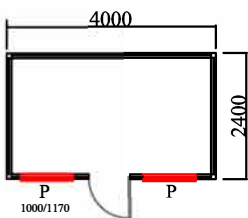

TİP KA 5

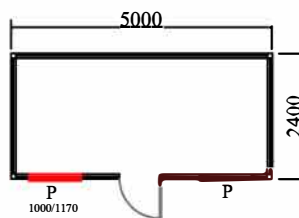

TİP KA 6

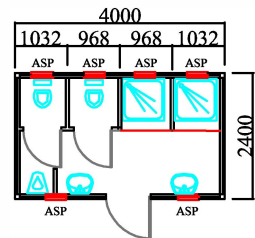

TİP KG 2

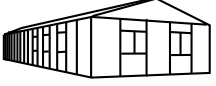

Panel Prefabrik Binalar

Taşıyıcısı çelik, dış ve iç kaplamaları betopan, ceopan yada sac olan yapılarımızdır. Yapıların yalıtımında yüksek dansiteli stropor veya cam yünü kullanılır. Panel duvarlarda en az betonarme yapılarda olduğu kadar ısı yalıtımı mevcuttur.

Yapılarımız; 184kg/m² kar yükü, 130 km/saat rüzgar yükü, 1. Derece Deprem Bölgesi (Yükler TS 498) ve 4. derece iklim Şartları (Erzurum, Kars...) olan binalar veya müşteri isteği doğrultusunda 80kg/m² kar yükü, 100 km/saat rüzgar yükü, 1. Derece Deprem Bölgesi (Yükler TS 498) ve 4. derece iklim Şartları (Erzurum, Kars...) olan binalardır. İstek dahilinde anahtar teslimi; elektrik, sıhhi tesisat, boya, mutfak dahil edilebilir.

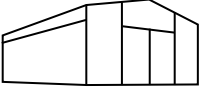

İzolasyonlu veya İzolasyonsuz Hangar Yapılar ve Depolar

Hangarlarımız, M profil denilen, laboratuvar çalışmalarında diğer profillere kıyasla daha çok yüke dayandığı tespit edilmiş bir taşıyıcıdan imal edilmektedir. Taşıyıcı profillerin üzerine yalıtımsız sac ya da yalıtımlı sandviç panel kullanılmaktadır. Hangarlarda mahya yüksekliği 8m'ye, bina enleri 20m'ye kadar çıkmaktadır.

Konteynerler

Tek veya çift katlı olarak inşa edilebilen konteynerler, şantiyeler için ofis yapıları, yemekhane, yatakhane, wc, duş yapıları ve deprem konutları olabilmektedir. Konteynerlerimizin demonte veya kaynaklı tipleri bulunmaktadır.

products

Panel Prefab Buildings

Buildings with steel frame system, inner and outer claddings are chipboard or steel sheet. Styrofoam is used for insulation. Heat insulation shall be available on panel walls as much as existed in reinforced concrete structures.

Our Buildings Bear:

Snow load: 184 kg/m², wind load: 130 km/hour, first degree earthquake area (Load regulation TS 498) and fourth degree climate conditions (coldest cities) OR Snow load: 80 kg/m², wind load: 100 km/hour, 1st degree earthquake area (Load regulation TS 498) and 4th degree climate conditions (coldest cities). Upon request: electricity, sanitary installations, painting and kitchen.

Insulated or Non-insulated Hangar Buildings and Warehouses

Our hangars are formed from "M profile". In lab studies it's proved that "M profile" bears more load than other profiles. For cladding insulated sandwich panels or steel sheets are used. Maximum ridge of the roof could be 8 meters. Widths of building reaches up to 20 meter.

Containers

Our containers could be single or multi storied and they could be used as office buildings for construction sites, refectories, dormitories, wc and shower buildings, storages and earthquake housings. There are both unassembled and welded types for the containers.













